



FLAT LED DOWNLIGHT FOR BATHROOMS  
AND ACCOMMODATION AREAS

<b>Design</b>	According to rules of maritime classification societies and relevant standards
<b>Housing</b>	Galvanized steel, powder coated white (RAL9016)
<b>Decorative ring</b>	White/chrome
<b>Cover</b>	Opal polycarbonate
<b>Mounting</b>	Fixing springs for ceilings max. 10 mm
<b>Connection type</b>	Connection cable with Ensto 2-pole plug
<b>Protection class</b>	IP44
<b>Weight</b>	0.2 kg
<b>Light source</b>	LED
<b>Wattage</b>	Max. 3 W
<b>CCT (color)</b>	2,700 K
<b>Luminous flux</b>	220 lm
<b>CRI</b>	≥ 80
<b>Current</b>	350 mA
<b>Electrical execution</b>	Driver or transformer required (not included) 5806005710-001 (Wago 3-pole plug)

#### PART NO.

DL100 white	5404000410-001
DL100 chrome	5404000410-002

#### EXTRAS

- > Different connectors
- > Different transformers
- > Different color temperatures
- > Different finishes

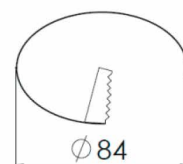
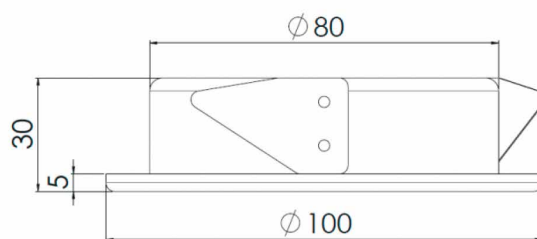

[mm]