



Part no. 2x 9 W 5111001500-016
1x 60 W 5111001600-001

Light source Incandescent or compact fluorescent lamp (not included)
Wattage (lamp base) 2x 9 W (2G7) 1x 60 W (E27)
Voltage 220-240 V AC
Frequency 50-60 Hz

Recessed mounted ceiling luminaire for cabins, dining rooms and accommodation areas

- Design** According to rules of maritime classification societies and relevant standards
- Housing** Galvanized steel, powder coated white (RAL9016)
- Trim ring** Steel, powder coated white (RAL9016)
- Diffuser** Opal polycarbonate, impact-proof
- Mounting** 8 mounting holes, \varnothing 4 mm
- Cable entry** 1 inlet for cables max. \varnothing 11 mm
- Wiring** Flexible wiring, heat resistant up to 105°C
- Protection class** IP44 in conjunction with ceiling
- Weight** Max. 1.3 kg

2x 9 W

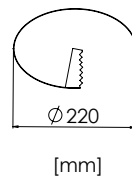
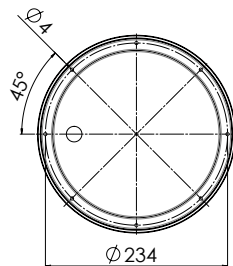
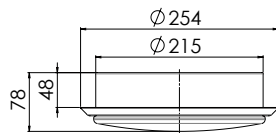
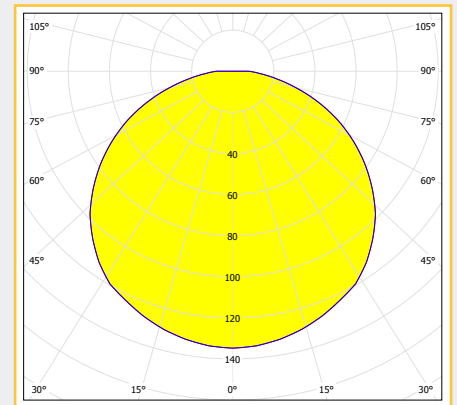

Extras

- 120 V AC execution
- B0- execution
- Electromagnetic ballast
- Chrome or gold plated trim ring
- Different cable entries on request
- Different wattages on request

Spare parts	Part no.
Trim ring RAL9016	7512000400
Diffuser	7112007500

