



Part no. 5101002300-005

Light source	HST/HIT lamp (not included)
Lamp Base	E40
Wattage	1x 150 - 400 W

### Watertight floodlight, max. 1x 400 W for HST/HIT lamps, IP68

Design	According to rules of maritime classification societies and relevant standards
Housing	Stainless steel, 1.4404 (AISI 316L) seamless deep drawn, with ignitor unit on right side, powder coated grey aluminium (RAL9007)
Cover	Borosilicated glass, 19 mm thickness
Mounting	Stainless steel bracket, adjustable
Reflector	Aluminium anodized, wide beam angle
Cable entry	Cable gland M25, nickel plated brass
Connection type	Rubber cable H07RN-F 3G2.5, 20 meters
Ballast	Ballast unit VG76 has to be ordered separately (see page 17)
Wiring	Flexible wiring, high temperature resistant
Protection class	IP68
Weight	16.0 kg

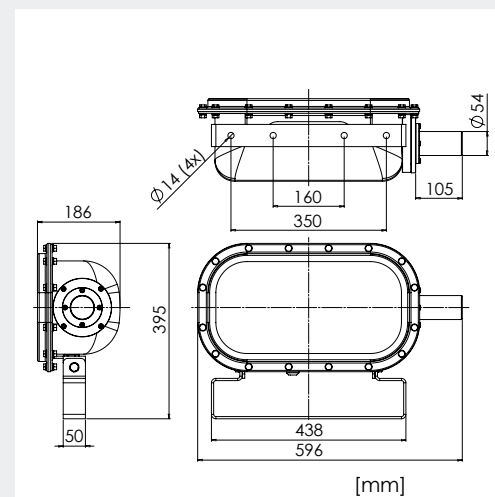
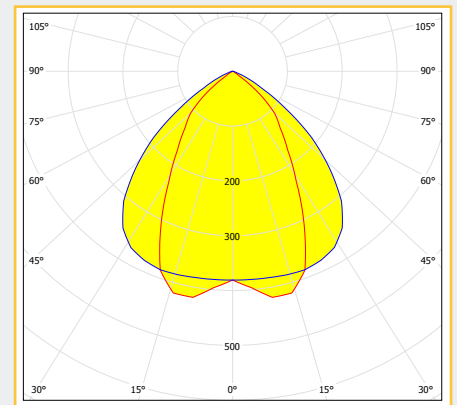

### Extras

- Narrow beam reflector
- Ignitor unit on left side of housing
- Different lengths of connection cable on request